

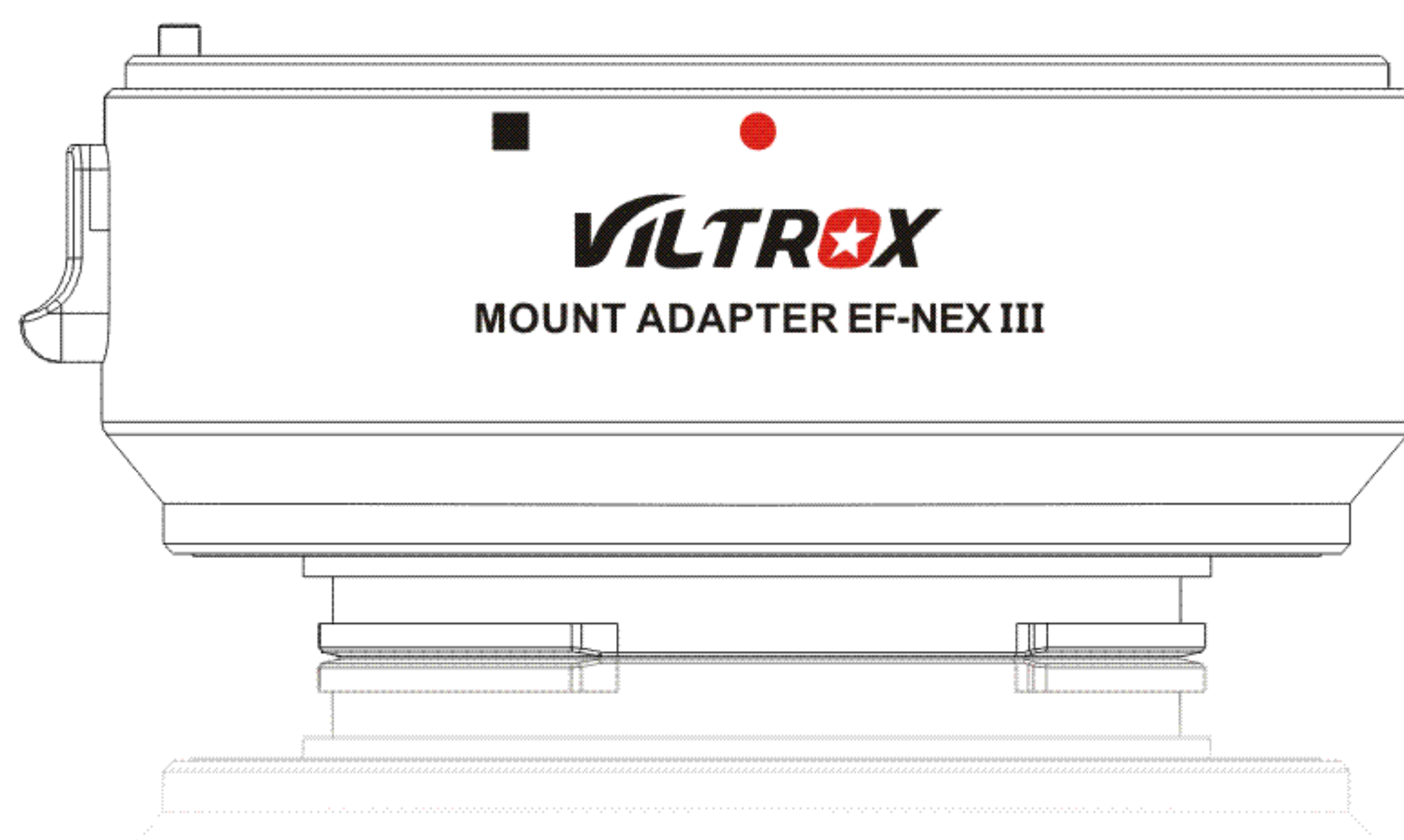

EF-NEX III MOUNT ADAPTER

Auto focus Support Sony full frame cameras



Thank you for using Viltrox mount adapter !

*Before setting the Viltrox mount adapter on your camera, please read this instruction so that all the function of the mount adapter will be implement.

Product function

Viltrox lens mount adapter EF-NEX III is designed to allow Sony E-mount series lenses to be used with E-mount lens compatible interchangeable-lens digital camera lenses.all the full frame features as bought along by this cameras.

Make sure the camera are compatible with the lens before using the adapter.Please read the manual carefully so that you can know more about proper operations before using the product.In order to help you refer later at any time ,pls take good care of the manual.

Attentions

1. If the adapter cannot work on NEX series cameras, please updated the camera to 04 or up version.
2. After set the adapter on the and lens, Be remember to set the M mode change to A mode. Please restart the camera if it cannot Auto focus.
3. Please use the switch on the lens to set the lens function.
If the settings in the camera menu and set on the lens, and is subject to the settings on the lens.
4. Please use the switch on the lens to set the lens function.
If the settings in the camera menu and set on the lens, and is subject to the settings on the lens.
5. When you use the lens is much heavier than the camera, be sure to move the camera and shoot holding the lens.
Will increase the minimum focusing distance of the lens adapter is connected, so the maximum magnification and field of view may change.

Name of each part

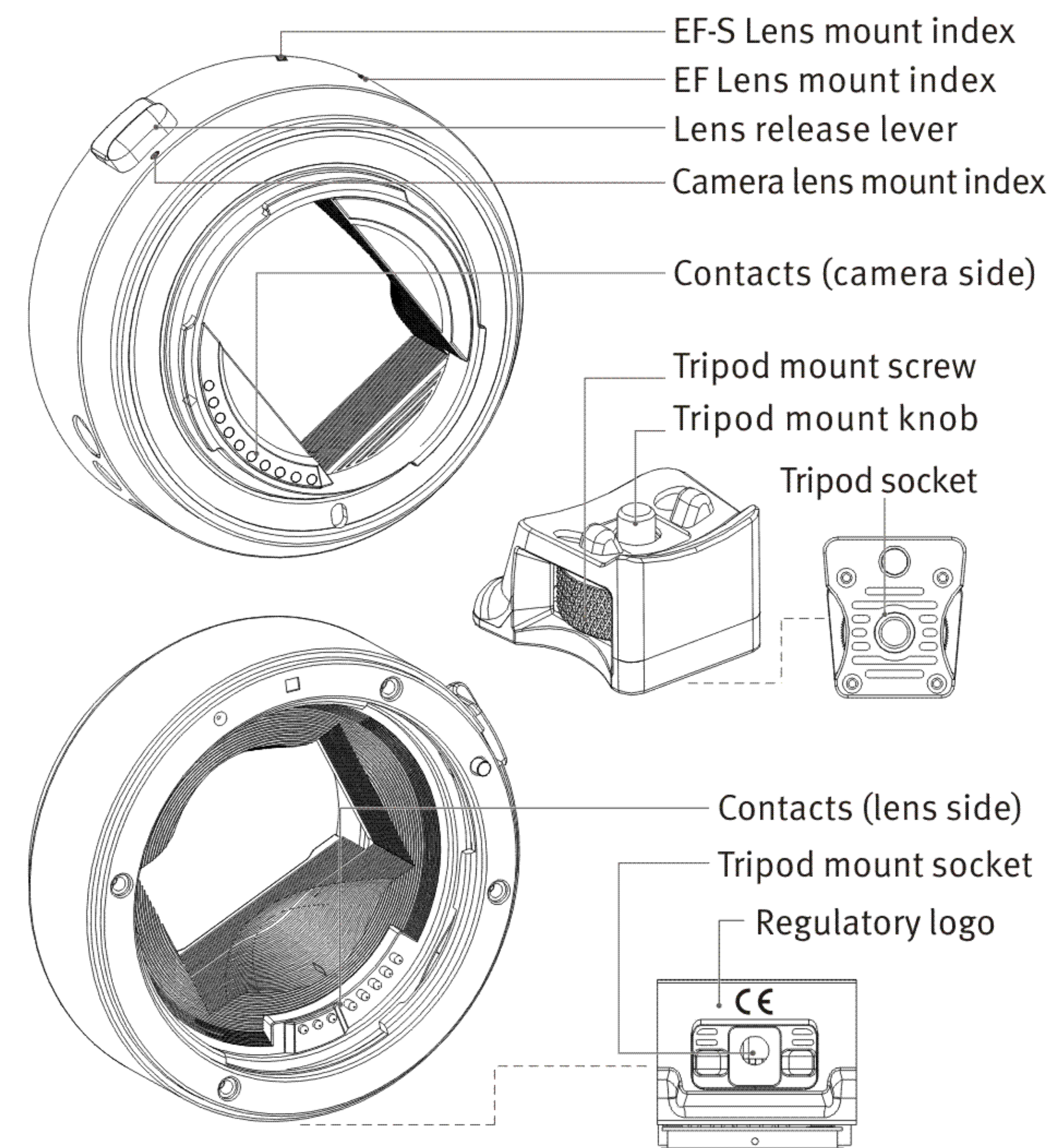

Mounting and Detaching the Adapter

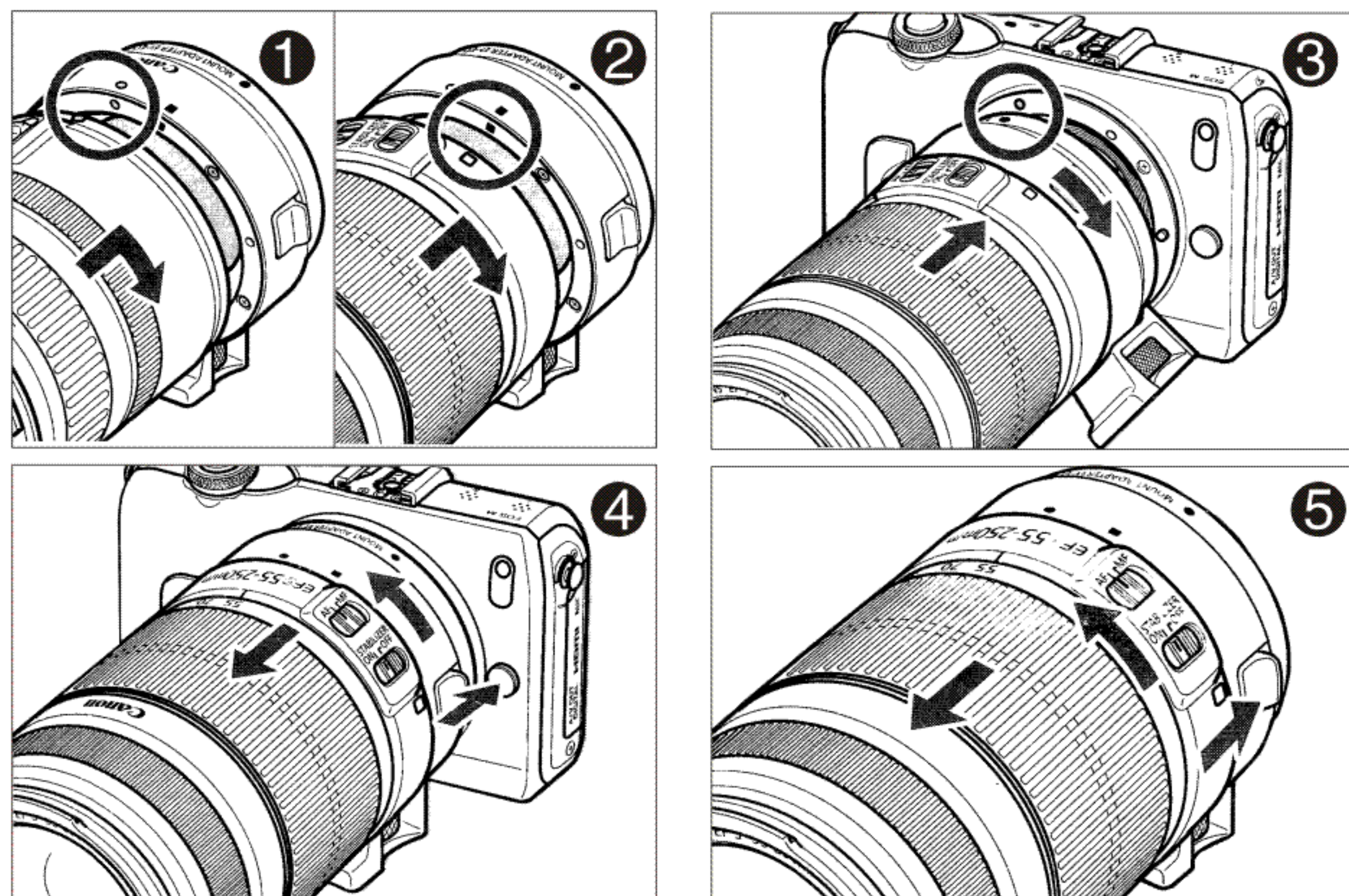

Mounting procedures

1. **Attach the EF lens to the EF mount side of the adapter.**
Insert the lens into the adapter by aligning the mount index found on the EF lens (red circle) with the same mark found on the adapter, and turn the EF lens clockwise until you hear a click. (fig. ①)
When attaching an EF-S mount index marks (white squares) and turn the lens clockwise. (fig. ②)
2. **Mount the adapter to the camera.**
Insert the adapter into the camera by aligning the Sony E-mount lens mount index found on the adapter (white circle) with the same mark found on the camera, and turn the adapter counter clockwise until you hear a click. (fig. ③)

Detaching procedures

1. **Turn the camera OFF, and detach the adapter from the camera while the EF lens is still attached to it.**
Turn the adapter counter clockwise while pressing the camera's lens release button. (fig. ④) Detach the adapter once it has stopped turning.
2. **Detach the EF lens from the adapter.**
Turn the EF lens counter clockwise while pushing the lens release lever found on the adapter (fig. ⑤). Detach the EF lens once it has stopped turning.
3. **Precautions when using this adapter with a tripod.**
When shooting with a tripod, do not use the camera's tripod mount socket while the adapter is attached. Be sure to use the tripod mount included with the adapter.

Attaching the tripod mount

1. Attach the included tripod mount to the adapter by firmly turning the tripod mount knob.
Please make sure that the tripod mount is facing in the correct direction in relation to the adapter.
2. Attach the tripod using the tripod mount socket. Securely attach the tripod while firmly holding the adapter.
3. **Precautions when using this adapter with a tripod.**
When shooting with a tripod, do not use the camera's tripod mount socket while the adapter is attached. Be sure to use the tripod mount included with the adapter.

⚠ When using a tripod with EF lenses that are equipped with a tripod mount, such as super telephoto lenses, please be sure to use it to mount the lens to the tripod.

Specifications

Compatible lenses	Canon EF series lenses
Compatible cameras	Sony E-mount series cameras
Front mount	Canon EF mount compliant
Rear mount	Sony E-mount compliant
Focus mode	Auto focus
Tripod Socket	Cu1/4"×1
Diameter and Length	66.6 mm × 26 mm
Weight	Approx. 141 g
Front cap	Camera cover
Rear cap	Lens Dust cap

Shenzhen Jueying Technology Co.,Ltd. www.viltrox.com
5/F,Blk 4, Baokun Science and Technology Industrial Park, Xialingpai,
Dalang Str.,Longhua,Shenzhen,China