

PADO

OZEN

VACUUM BLENDER

User Manual
HB310

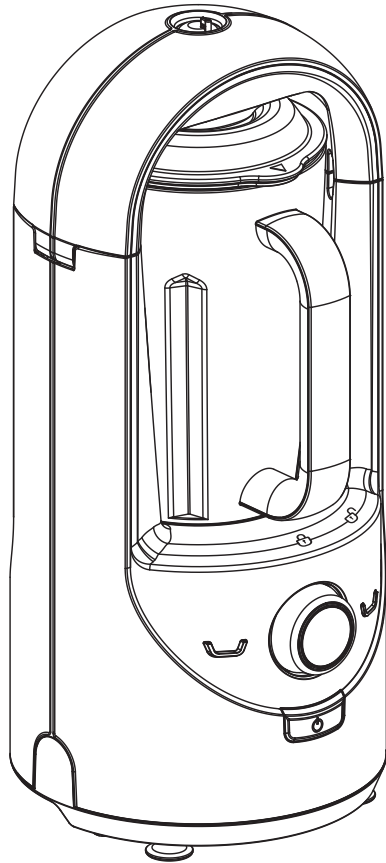

- Make sure the user manual is easily accessible and read "Important Safeguards" prior to using this product.
- This product is for home use (domestic use) and its commercial and industrial use is prohibited.
- Color and function may be different depending on the model.

Features

Bubble Free Blending

Vacuum blender produces bubble free soft beverages.

Keep Nutritional Contents

Blending in tight vacuum restricts initial oxidation to keep the nutritional contents of the food for a long time.

Powerful Pulverizing Action

Using powerful pulverizing action, you can conveniently prepare and enjoy the juice with even the materials high in dietary fiber.

Elegant Design

The modern design fits the kitchen interior well.

Easy Speed Control

You can easily adjust the blending speed according to the characteristics of the materials and the recipe to prepare various dishes.

Safety Device

The double safety device disables the product when the vacuum cap is open or when the vacuum container is not set properly in order to prevent possible accidents in advance.

Convenient Use

The smart mode lets you enjoy vacuum blended beverage and enjoy various recipes without going through complicated processes.

Contents

| | |
|---|-------|
| • Important Safeguards | 2~6p |
| • Part Names and Components | 7p |
| • Vacuum Container Components | 8p |
| • How to Use and Control Product | 9~11p |
| • Managing Product after Use | 12p |
| • Please Check before Reporting Trouble | 13p |

- This product is for home use (domestic use).
- Read this manual carefully before use. Please note that the damages from the use of the product outside the contents of this manual will not be remedied by damage compensation according to the Consumer Protection Act.

IMPORTANT SAFEGUARDS

When using electrical appliances, basic safety precautions should always be followed including the following:

1. Read all instructions.
2. To protect against the risk of electrical shock, do not put the blender base in water or other liquid.
3. Close supervision is necessary when any appliance is used by or near children.
4. Unplug from outlet when not in use, before putting on or taking off parts, and before cleaning. Allow to cool before handling.
5. Flashing light indicates ready to operate. Avoid any contact with blades or moveable parts.
6. Do not operate any appliance with a damaged cord or plug or after the appliance malfunctions, or is dropped or damaged in any manner. Return appliance to the nearest authorized service facility for examination, repair, replacement, or electrical or mechanical adjustment.
7. The use of attachments, including canning jars, not recommended by the manufacturer may cause a risk of injury to persons.
8. Do not use outdoors.
9. Do not let cord hang over edge of table or counter.
10. Do not let cord contact hot surface, including the stove.
11. Do not place on or near a hot gas or electric burner or in a heated oven.
12. Do not use appliance for other than intended use.
13. Keep hands and utensils out of container while blending to reduce the risk of severe injury to persons or damage to the blender.
14. A scraper may be used, but must be used only when the blender is not running.
15. Blades are sharp handle with care.
16. To reduce the risk of injury, never place cutter-assembly blades on base without jar properly attached.
17. Never attempt to operate with damaged blades.
18. Always operate blender with cover in place.
19. Do not blend hot liquids.
20. This appliance is for household use only.

SAVE THESE INSTRUCTIONS



Important Safeguards

- ※ The safety related information in the following is intended to prevent unpredicted danger or damage by guiding the customer to use the product safely and properly.
- ※ The safety related cautions for this product comply with certified technical standards and the electric safety standards.



Warning

1. Use a proper outlet for the electric capacity of the product. Do not connect or disconnect the plug by the cord; do so by the plug.

- ※ It can cause fire, electric shock, or electric leakage.
- ※ This appliance has a polarized plug (one blade is wider than the other). To reduce the risk of electric shock, this plug will fit in a polarized outlet only one way. If the plug does not fit fully in the outlet, reverse the plug. If it still does not fit, contact a qualified electrician. Do not modify the plug in any way.

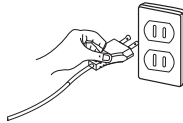

2. Do not bend, tie, or pull the power cord by force.

- ※ It can cause electric shock or fire.

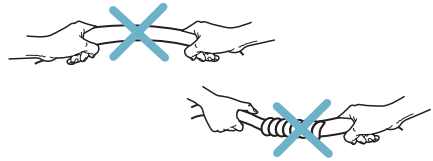

3. Clean the dirt on the power plug. Do not touch or connect the power cord with wet hand.

- ※ It can cause electric shock.

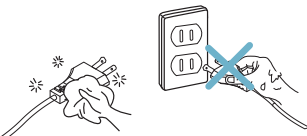

4. Do not disassemble or remodel the product or press the safety device by force in order to start the product.

- ※ It can cause trouble, fire, electric shock, or injury.

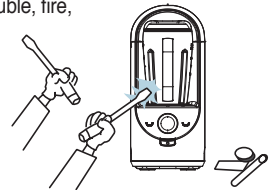

5. Do not place the product in a hot and humid area or near electric heater or inflammable substances.

- ※ It can cause fire, electric shock, or other safety accidents.

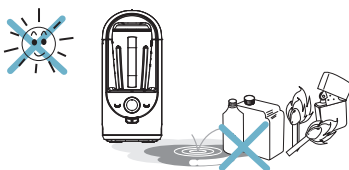

6. Do not wash the main body in water. Do not use dish washer or dish dryer for the product.

- ※ It can cause trouble, fire, or electric shock.
- ※ Remove dirt using dampened dry cloth.

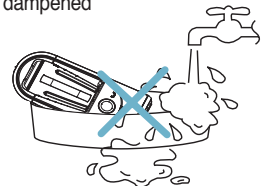

- ※ The following symbols are used to remind the user of the matters and operations that can lead to danger.
- ※ Read the descriptions carefully and follow the instructions to void danger.



Warning Refers to the case where the noncompliance with instructions can lead to serious injury or death.



Attention Refers to the case where the noncompliance with instructions can lead to light injury or product damage.

Warning

7. Max. pulse operation time is 1 minute. When using it continuously, do not use it more than 3 times
- ※ It can cause damage to the product.
 - ※ The motor will stop automatically when the safety device (temperature sensor) is activated to prevent the motor's overheat.
 - ※ This is not a defect. Cool down the motor for at least 30 minutes and then try again.

8. Do not put hot water (104°F or hotter) or materials.

- ※ Be careful if hot liquid is poured into the blender as it can be ejected out of the appliance due to sudden steaming.
- ※ It may cause damage or injury to the product.

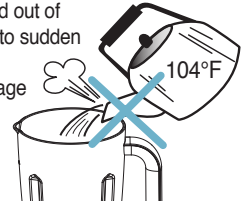

9. Do not open the vacuum cap or move the product in use. After use, turn off the power and open the vacuum cap after the knife comes to a complete stop.
- ※ It can cause injury or damage.



10. Do not place the product on an unstable place where it might fall easily. Do not place the product on a rug or cushion.

- ※ It can cause electric shock and safety accident.

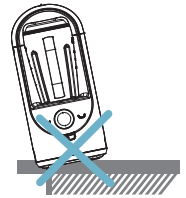

11. Do not idle the blender while the vacuum container is empty. For ice and solid materials, peel off and break into pieces to use with other materials containing moisture. (Refer to page 11.)
- ※ It can cause damage or fire.



12. This appliance can be used by children aged from 8 years and above and persons with reduced physical, sensory or mental capabilities or lack of experience and knowledge if they have been given supervision or instruction concerning use of the appliance in a safe way and understand the hazards involved. Children shall not play with the appliance. Cleaning and user maintenance shall not be made by children without supervision.



 CAUTION

1. When you open or close the vacuum cap, do not use excessive force, and make sure the vacuum container does not bump into vacuum cap.

※ It can cause breakage.

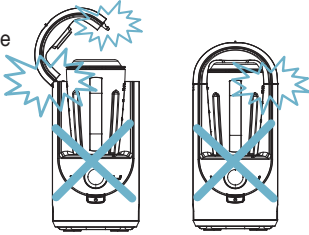

2. Do not apply extreme shock to the product or drop the product.

※ It can cause trouble and problems with safety.

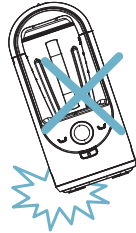

3. Do not clean the product with paint thinner, benzene, or insecticide.

※ It can damage the appearance through discoloration or exfoliation.

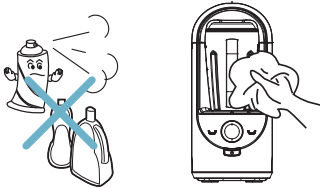

4. When disassembling the blade body for washing, take cautions to avoid injury by the sharp blade. (Wear protective gear)



5. If the product generates a strange sound or odor while in use, pull out the power plug immediately and contact customer support center.

※ If you run the blender at a high RPM, it can produce a slight smell due to the friction of the motor. However, this is not a defect.

6. Disconnect power plug when the product is not in use, or to store or wash the product.

※ If the supply cord is damaged, it must be replaced by the manufacturer, its service agent or similarly qualified persons in order to avoid a hazard.

7. Use the product for designated uses only. (Do not use the product for kneading, mincing, pulverizing, or for dried food materials) Do not put the product and its parts into boiling water or a microwave.

※ It may cause damage or injury of the product.

8. This appliance is not intended for use by persons (including children) with reduced physical, sensory or mental capabilities, or lack of experience and knowledge, unless they have been given supervision or instruction concerning use of the appliance by a person responsible for their safety. Children should be supervised to ensure that they do not play with the appliance

CAUTION

9. Do not leave foreign objects, such as spoons, forks, knives or the lid plug, in the container. Always operate blender with cover in place.
 * It can cause injury and product damage.



10. After blending, separate the container after the blade comes to a complete stop. Wash the blade and container immediately and store after completely dried.
 * If not, it can become the cause of foul odor, bacterial propagation, and corrosion.

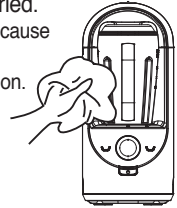

11. After each use, the container lid must be washed for next use. (Refer to page 12)
 * If the expanding bubble or food material goes into the backflow prevention cap on the container lid, it can cause trouble



12. Do not use the exclusive container and designated parts with other devices or undesignated parts.
 * It can cause breakage.

13. After vacuuming, keep the food in the refrigerator (**never in the freezer**)
 * It does not have sterilizing effect. Take cautions when storing food.

14. Do not use carbonated beverage, sticky food (boiled bean, etc.).
 * It can cause injury or breakage.

15. Take cautions to make sure the food material does not go into the safety device.
 * It can cause injury or breakage.

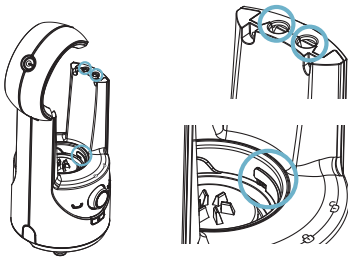

16. Keep the maximum or the minimum volume for each type of material. (Refer to page 11)
 * It can cause breakage.

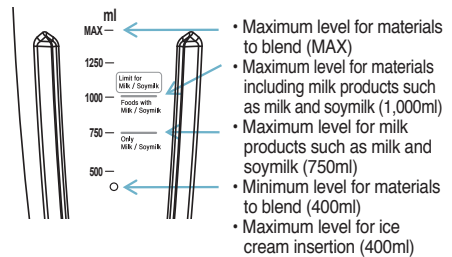

17. When disposing used appliances as waste, follow designated disposal procedure.



Part Names and Components

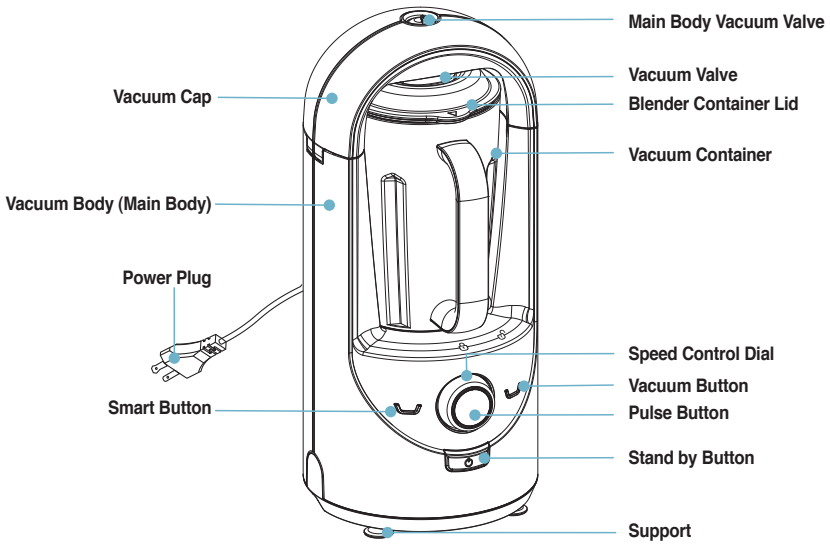

Dimensions

- Model Name: HAF-HB300 / HB310 / HB311
- Rated Operating Hours: Short within 1 minute
- Dimensions: 200(W) X 220(D) X 448(H)
- Weight: 3.4kg

Components

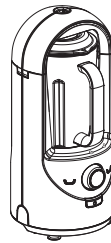

1 Set of Vacuum Blender



Sub Vacuum Container



User Manual



Vacuum Container Components

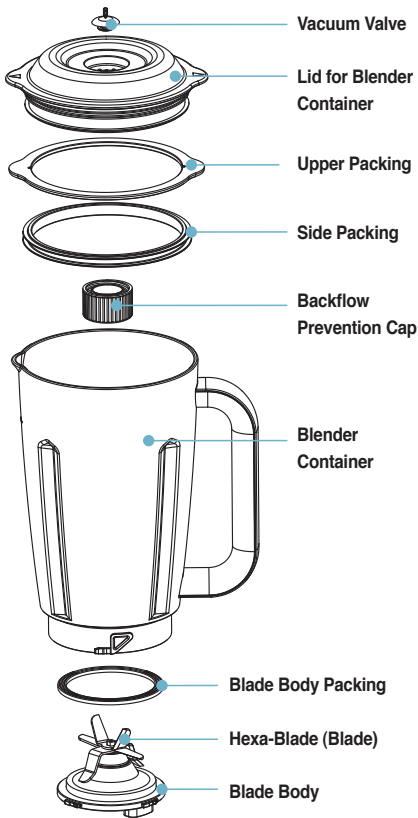

Sub Vacuum Container Components

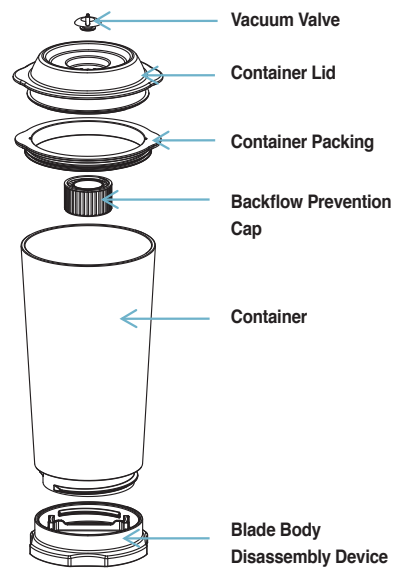

※ When disassembling or assembling the vacuum container for washing

- Blade is sharp. Take cautions to avoid injury!
- Make sure you do not miss any components!
- Make sure you do not damage the packing!
- Disassemble the backflow prevention cap and blade body by turning them counterclockwise and assemble them by turning them clockwise. (Refer to page 12 for details)



How to Use and Control Product

1. Open the blender container lid, put an appropriate amount of materials, and close the lid. (Refer to page 11 for volume of materials). Match the bump on the container's pouring section and the bump on the lid. (If not, the vacuum may not work.)

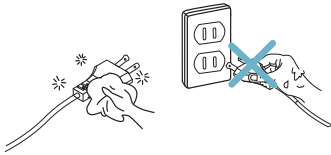

2. Open the vacuum cap of the blender's main body to the left and turn the container until its handle comes to "Open" position to set it on the main body.

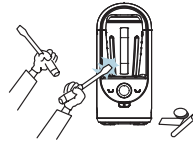

3. Turn the vacuum container clockwise until the handle comes to the "Lock" position on the front side.

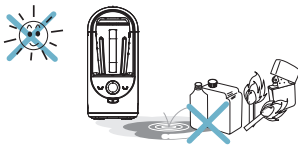

4. Completely close the vacuum cap that you had opened to the left.



5. Check if the vacuum container and vacuum cap are connected properly.

- ※ If the vacuum container is not set properly, all lamps on the front side will flicker with the buzzer sound while the blender is in use. Press the Stand by button to cancel the buzzer and check whether the container is set properly.

6. Press the Stand by button to turn on the blender and use the required function to prepare the materials.

- ※ All lamps on the front side will be on when the container is set properly and is ready. Check before use!
- ※ Flashing light indicates ready to operate. Avoid any contact with blades or moveable parts.

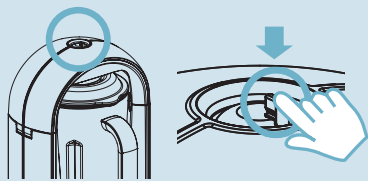

- ※ If an error occurs without the operation being complete, the problem may be due to loose seal. Tap the top of the vacuum valve in the main part when the vacuum starts.

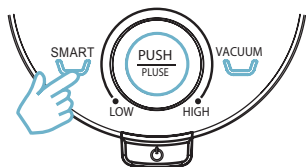
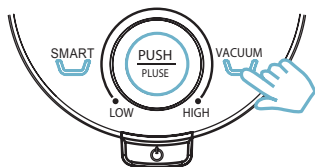
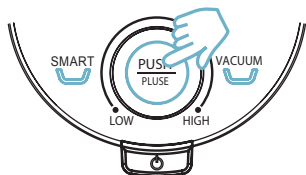
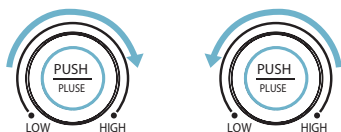
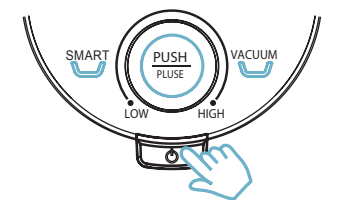

7. Turning on the power

Connect the power plug of the main body to 220V outlet, press the stand by button to turn on the lamps on the control panel with the signal sound. Lamps will turn on partially when the vacuum container is not set properly or when the vacuum cap is not closed properly. The blender function will not operate when the lamp is not on.

- ※ Even when the power is off, a small amount of electricity is flowing through the product.
- ※ This switch is for stand by to product by for use, not for completely turn it on/off.

8. Speed Control

Turn the speed control dial clockwise to start the blender. The blending speed increases by the ratio of turning the dial, and decreases to a stop when the dial is turned the other way around.

(Lamp will flicker at various rates depending on the blending speed.)

- ※ The blender will stop when you press Pulse button while controlling the speed.
- ※ It will operate for a fixed period of time and stop automatically.

9. Pulse

When you press the pulse button on the speed control dial, the blender will instantly run at full power.

(Dial's lamp will flicker at a fast rate.)

10. Vacuum

When you press the vacuum button, it will automatically set vacuum pressure. The lamp will flick during vacuum action, and it will stop when you press the button again.

- ※ When an error occurs, the vacuum and pulse lamps will flicker simultaneously with the buzzer sound, and this will be cancelled when you press the stand by button again. Check the connection between vacuum container and main body and the vacuum valve for trouble.

11. Smart

When you press smart button, it will automatically carry out vacuum, pulse, and blend functions in respective order and also automatically stop without additional control of the user.

Laps will flicker when the blender is running and stop when you press the smart button again.

- ※ When an error occurs, the smart and pulse lamps will flicker simultaneously with the buzzer sound, and this will be cancelled when you press the stand by button again. Check the connection between vacuum container and main body and the vacuum valve for trouble.



How to Use and Control Product



- ※ Before using the product make sure that the blade body is inserted all the way into the connecting part of the container. When loosely assembled, the contents may pour out and cause malfunction.
- ※ You can easily assemble/disassemble the blade by using the blade body decomposing part of an auxiliary container with the blade body.



12. Release of Vacuum

When you are removing the vacuum container after vacuum blending, you must open the vacuum valve on the top to release vacuum in order to open the vacuum cap and separate the container. You must also release vacuum by opening the vacuum valve on the top of the lid in order to open the vacuum container.

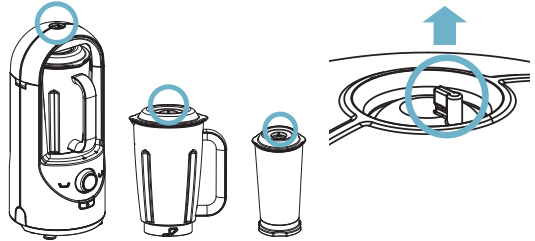

13. Sub Vacuum Container (Storage Container)

You can keep blended juice or other foods in vacuum using the storage container to keep them fresh for a long time. (Vacuum delays oxidation but does not sterilize the contents. Keep them refrigerated and have them as soon as possible.) Some food products, including fruits, emit gas. In such case it may seem that the vacuum container does not preserve food well, even when in fact, it is well sealed.

14. Maximum Level

Do not exceed the maximum level for each food material indicated by the scale on the container. Bubble or food materials getting into the vacuum pump can cause trouble.

15. Minimum Level

All materials must be inserted above the minimum (MIN) level indicated by the scale on the container. If not, the blade will idle and will not be able to crush the materials, and this can lead to trouble and performance problem.

How to Insert Food Materials

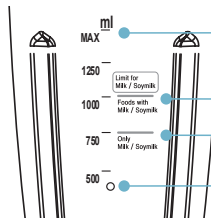

■ Maximum level for materials to blend (MAX)

■ Maximum level for materials including milk products such as milk and soymilk (1,000ml)

■ Maximum level for milk products such as milk and soymilk (750ml)

■ Minimum level for materials to blend (400ml)

■ Maximum level for ice cream insertion (400ml)

- ※ If the material is too large or too thick, the contents might not be blended well. In this case, add liquid such as water or milk.
- ※ If you put ingredients over the reference mark of the container, expanded content may suck in to the backflow prevention cap during vacuum and cause malfunction of the vacuum pump. Please make sure to stop the operation before reaching the backflow prevention cap.

16. Powdered Materials / Dry Materials

Powdered materials shall be completely dissolved in water or beverage for use, and dry materials shall not be used by themselves.

17. Ice and Solid Materials

Ice and solid materials shall not be used by themselves; break into small pieces and insert in the following order.

- ① Liquid such as water or beverage → ② Watery or soft materials → ③ Light materials → ④ Ice or solid materials



Managing Product After Use

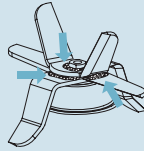

- * Leftover food residue stuck in blades may appear to be rust.
- * Soak and brush the blades in water with baking powder.
The blade body is not waterproof

- * Make sure the components such as packing and backflow prevention cap are not missing when reassembling them after washing.

1. Cleaning Container

To wash the container and the blade, fill half of the container with water, assemble it to the main body, and run for 15 seconds to wash the remnants caught in the blades easily. Do not operate the product with foaming detergent in it. (The foam can cause product damage.)

* Cautions for Disassembling and Cleaning Blade

Blades are sharp. Take cautions to avoid injury. Using the blade disassembly device as in the picture on the right, turn it counterclockwise to disassemble and clockwise to assemble.



2. Washing Blade Body

Blade body is not waterproof. Do not put it directly into the water. Wash only the blades using the brush under running water in order to prevent corrosion and remove moisture completely. If there is dirt on the bottom of the blade body, clean it with soft cloth or kitchen cloth.

* Blades are sharp. Take cautions to avoid injury. (Wear protective gear.)



3. Washing Lid

After each use, wash the lid and remove moisture, for next use.

If a large quantity of blended materials spattered on it, separate and wash the backflow prevention cap on the container lid and dry it well before use.

If the vacuum valve is spattered with food, it can block the vacuum passage and cause trouble. Take cautions to avoid trouble. In case the valve is spattered with food, separate and wash the vacuum valve and dry it well before use.

* Assembly and Disassembly of Backflow Prevention Cap

Turn it counterclockwise as in the picture on the right to disassemble and clockwise to assemble.

* Assembly and Disassembly of Vacuum Valve

Pull up as in the picture on the right to disassemble and press down to assemble.

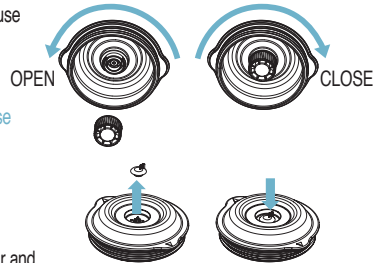

4. Cleaning Main Body

Clean the main body using a small amount of neutral detergent mixed in warm water and soft cloth or kitchen cloth.

* Do not sprinkle water or other liquid agents on the main body or do not put the main body into water. It can cause fire or electric shock.

* If the water gets inside the main body, dry it thoroughly before use.

5. Storing after Cleaning

When storing after washing, completely wipe and dry the product and store it in a well-ventilated place away from heat or direct sunlight.

6. Other Cautions

You must turn off and unplug the product before cleaning or storing the product.

* Rough and sharp tools such as steel wool or steel brush can damage the product to cause leakage of materials or vacuum failure. Do not use such tools. For the risk of fire, never use benzene, paint thinner, and wax.

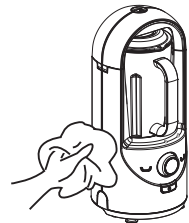



Please Check before Reporting Trouble

- * When you experience the following symptoms while using the product, check again.
It may not be a trouble.
- * When the error occurs, turn off the power, unplug the product, and then take measures.

Buzzer / Lamp Reaction to Errors

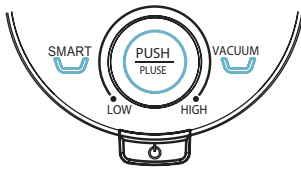

| Error Action | Lamps | Buzzer Sound |
|---------------------|------------------|--|
| Smart Error | Smart and Pulse | Beep - Beep - Beep - Beep - Beep - (5 times) |
| Vacuum Error | Vacuum and Pulse | Beep - Beep - Beep - Beep - Beep - (5 times) |
| Safety Device Error | All | Beep - Beep - Beep - Beep - Beep - (5 times) |

For following symptoms

Take following measures

- | | |
|----------------------------------|--|
| Q It is not working at all. | <p>A Check whether the earth leakage breaker is down or whether the power cord is unplugged.</p> <p>A Check whether the vacuum container is set on the main body properly or whether the vacuum cap is closed properly.</p> |
| Q It stops while in use. | <p>A Check whether the earth leakage breaker is down or whether the power cord is unplugged.</p> <p>A Did you use the product continuously for a long time? When the motor overheats, it is designed to stop automatically for safety and run again when it cools down. Cool down the motor fully for 30 minutes and try again.</p> <p>A Check whether materials are caught in the blades.</p> <p>A Check whether the vacuum cap is open or whether the vacuum container is loosened from the main body.</p> |
| Q Materials not pulverized well. | <p>A Did you put too much or too little materials? Refer to how to feed food materials in page 11.</p> <p>A Check operating voltage. Voltage is indicated on the bottom of the product.</p> |
| Q Materials are leaking. | <p>A Check whether the vacuum container is set on the main body properly and whether the container's lid or blade body are connected to the container properly.</p> <p>A Check whether the container's lid or blade packing is damaged and if it is, then contact retailer or customer service center.</p> |
| Q Vacuum is not working. | <p>A Check whether the vacuum container components such as packing and backflow prevention cap are assembled properly.</p> <p>A Check whether the container's lid is contaminated. If it is, clean it according to the descriptions in page 12.</p> <p>A Check if the container cover seal is in correct position and press the upper part of vacuum valve as it starts vacuuming. (Consult p.9~10)</p> |

PADO | **OZEN**
VACUUM BLENDER



5 STAR SERVICE COMMITMENT

PADO, Inc. is committed to providing the very best in customer care.

We urge you to contact our support staff with any questions, or issues regarding your OZEN blender.

You can reach us at (866) 528-1010 or at support@padousa.com

PADO, Inc.

28340 Ave Crocker, Suite 100 Valencia, CA 91355
www.padousa.com