

**PHILIPS**

Portable speaker

SB300



# Quick Start Guide

Register your product and get support at [www.philips.com/support](http://www.philips.com/support)

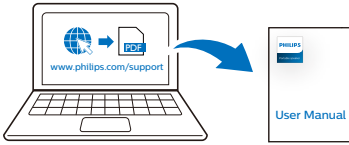

[www.philips.com/support](http://www.philips.com/support)



Specifications are subject to change without notice. This product has been manufactured by, and is sold under the responsibility of Gibson Innovations Ltd., and Gibson Innovations Ltd. is the warrantor in relation to this product. Philips and the Philips Shield Emblem are registered trademarks of Koninklijke Philips N.V. and are used under license.



SB300\_00\_QSG\_V2.0

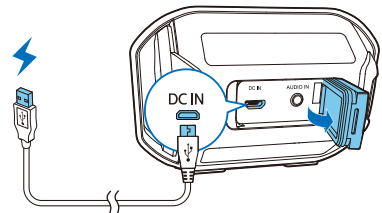
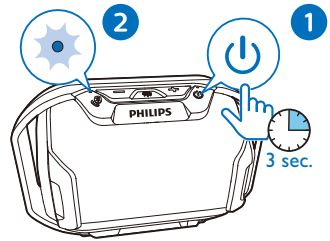
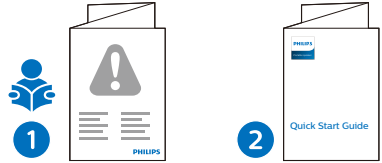
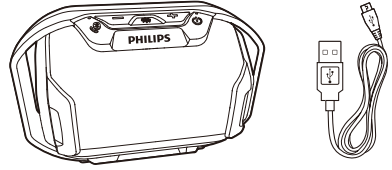



1

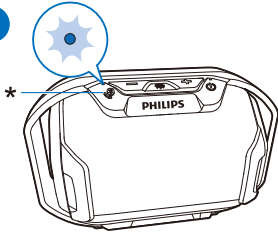

2

