

OSMO⁺

Quick Start Guide

V1.0

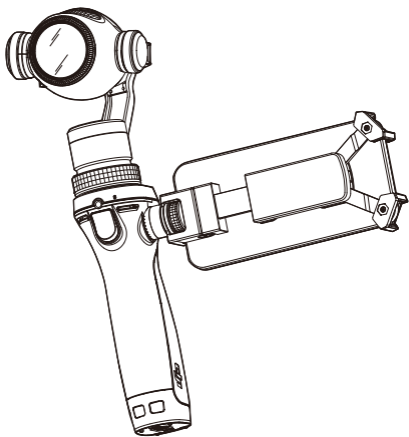

Overview

The OSMO™+ is a professional handheld gimbal camera that combines mobility and stability in one device. Its camera features an optical zoom lens providing 3.5x optical zoom and 2x lossless digital zoom. It shoots sharp 12MP still photos and stable video at up to 4K. A mobile device can be mounted on the side of the handle to display a live feed from the camera through a high-speed Wi-Fi video link.

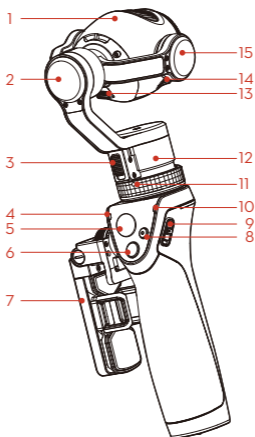

- | | |
|------------------------|--------------------------|
| 1 Camera | 10 System Status LED |
| 2 Roll Motor | 11 Gimbal Securing Ring |
| 3 Pan Axis Lock | 12 Pan Motor |
| 4 Camera Status LED | 13 Camera Micro USB Port |
| 5 Joystick | 14 Micro SD Card Slot |
| 6 Shutter Button | 15 Tilt Motor |
| 7 Mobile Device Holder | |
| 8 Record Button | |
| 9 Power Switch | |

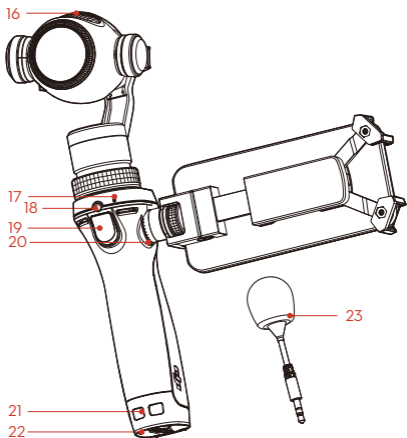

- 16 Air Vents
- 17 Built-in Microphone
- 18 External Microphone Input
- 19 Trigger
- 20 DJI Rosette Mount
- 21 Lanyard Hole
- 22 Battery Cover
- 23 Flexi Microphone

Specifications

• Handle

Dimensions	2.4×1.9×6.4 inches (61.8×48.2×161.5 mm)
Weight (including battery)	201 g
Supported Mobile Device	Max Size: 6.2 (L) × 3.1 (W) inches 158.2 (L) × 77.9 (W) mm

• Gimbal

Model	Zenmuse X3 Zoom
Weight	268 g
Output Power (with camera)	8 W
Angular Vibration Range	±0.02°
Mount	Detachable
Controllable Range	Tilt: -35° to +135° Pan: ±320°; Roll: ±30°
Mechanical Range	Tilt: -50° to +140° Pan: ±330°; Roll: -50° to +90°
Max Controllable Speed	120°/s

• Camera

Model	X3 ZOOM / FC350Z
Sensor	Sony Exmor R CMOS; 1/2.3" Effective pixels: 12.40 M (Total pixels: 12.76 M)
Lens	3.5× Optical Zoom, 22 – 77mm Equivalent F2.8 (Wide) – F5.2 (Tele), FOV 92° (Wide) – 35° (Tele) Focus: 0.5 m to infinity
ISO Range	100 – 3200 (video); 100 – 1600 (photo)
Electronic Shutter Speed	8 s – 1/8000 s (up to 30 s when camera is in M mode)
Max Image Size	4000×3000 pixels
Still Photography Modes	Single Shot Photo Burst Mode: 3/5/7 shots Auto Exposure Bracketing (AEB): 3/5 bracketed frames @ 0.7 EV bias Interval Auto Panorama Selfie Panorama
Video Resolution	UHD: 4K (4096×2160) 24/25p 4K (3840×2160) 24/25/30p 2.7K (2704×1520) 24/25/30p FHD: 1920×1080 24/25/30/48/50/60/100p
Video Recording Modes	Auto; Slow Motion
Max Video Bitrate	60 Mbps
Supported File Systems	FAT32 (≤ 32 GB) ; exFAT (> 32 GB)
Photo Formats	JPEG, DNG (RAW)

Video Formats	MP4/MOV (MPEG-4 AVC/H.264)
Supported SD Cards	Micro SD; Max. Capacity: 64 GB Class 10 or UHS-1
Operating Temperature	32° to 104° F (0° to 40° C)
Audio Output	48 KHz; AAC

• **WiFi Video Link**

Operating Frequency	2.412 – 2.462 GHz; 5.180 – 5.805 GHz
Max Transmission Distance	82 feet (25 m)
Transmitter Power (EIRP)	2.4G: 8 dBm; 5G: 12 dBm

• **Intelligent Battery**

Model	HB02-542465
Type	LiPo
Capacity	1225 mAh
Energy	14.1 Wh
Voltage	11.55 V
Charging Temperature	41° to 104° F (5° to 40° C)
Operating Temperature	32° to 104° F (0° to 40° C)

• **Battery Charger**

Model	OS1C11
Input	100 – 240 V; 50/60 Hz
Output	12.6/13.2 V, 0.8 A

• **Flexi Microphone**

Sensitivity	-32 ± 3 dB (0 dB = 1 V/Pa)
Frequency Response	100 – 10000 Hz
Signal-to-Noise Ratio	60 dBA
Pin Diameter	3.5 mm
Length	88 mm
Weight	4 g

Optional Accessories

Extension Rod

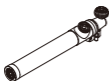

Tripod



Osmo Z-Axis



DJI provides various optional accessories for the Osmo+. Visit the DJI Online Store for more information: <http://store.dji.com>

1. Install the DJI GO App

Search for 'DJI GO' on the App Store or Google Play, or scan the QR code to download the app on your mobile phone.



- DJI GO supports iOS 8.0 (or later) and Android 4.3 (or later).

2. Prepare the Battery

Fully charge the battery before using it for the first time. Insert the battery as shown.

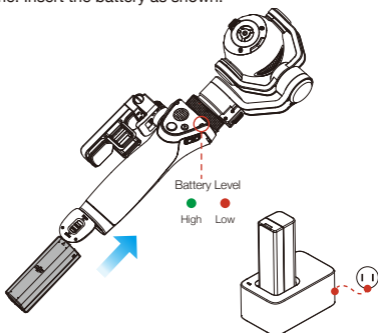

- Charge Time: ~110 minutes.
- The LED indicator will become solid green when charging is complete.

3. Mount your Mobile Device

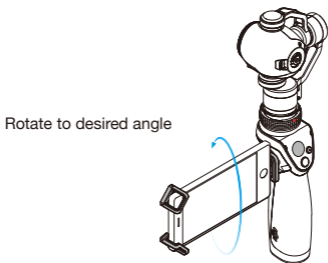
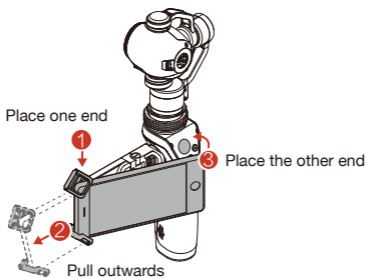
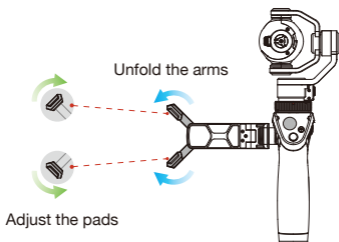

- Ensure your mobile device is fully seated.

4. Unlock the Gimbal

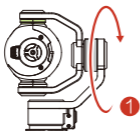

1. Rotate the tilt motor

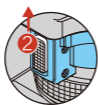

2. Slide the Pan Axis Lock up

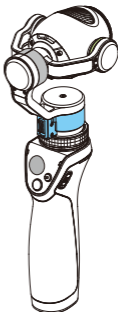

5. Connect to the DJI GO App



To Power On:
Pull down on the switch

Pull down again > Sleep

Pull down and hold for 1.5 s > Power Off



Turn on your mobile's WiFi and
connect to **OSMO_XXXXXX**
Default password: 12341234



Launch the app and tap Camera.



Activate the Osmo+ when using it for the first time.
This requires an internet connection.

6. Controls

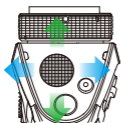

- Use the joystick to pan or tilt the camera.

- Position the camera directly by hand.

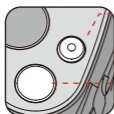

- **Record Button**

Press once to start recording, and again to stop recording.

- **Shutter Button**

Press once to take a photo. Press and hold for burst capture.

- **Trigger**

Hold down the trigger and push the joystick up and down to zoom.

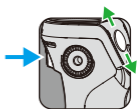

Hold down to enable Lock Mode.

Tap twice to center the camera.

Tap three times to enter Selfie Mode.



- SmoothTrack Mode is enabled automatically to smooth out jerky movements.
- The Osmo+ will beep slowly if the gimbal is locked after it is turned on. This means the camera is working normally but the gimbal is shut off.
- If you need to unlock the gimbal after it is turned on, you must rotate the pan motor after unlocking the tilt motor and pan motor to reactivate the gimbal.

For more information, read the User Manual:

<http://www.dji.com/product/osmo-plus>

※ This content is subject to change without prior notice.

OSMO⁺

www.dji.com